

Flat Panel Console with Swinging Floater PRO-5

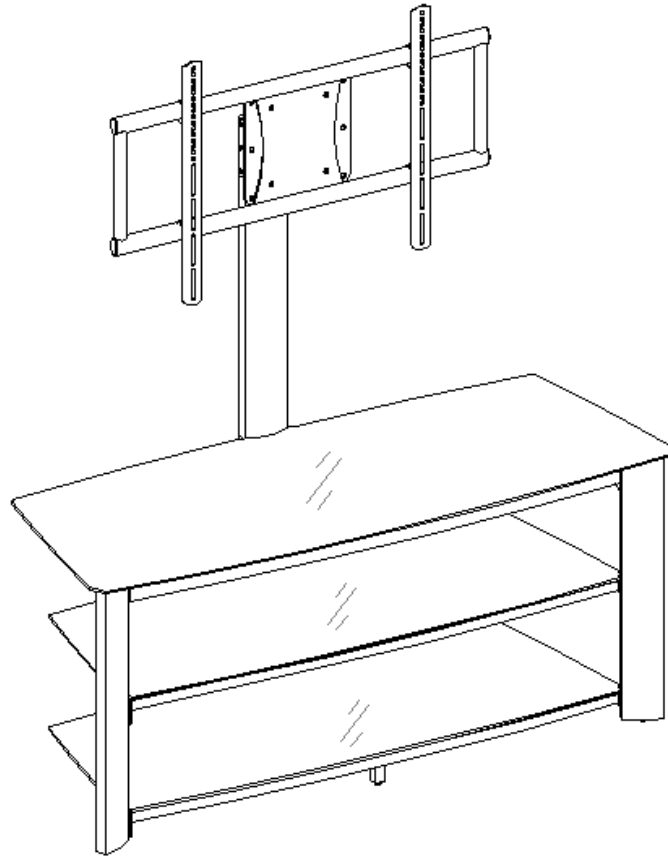

2 ADULTS REQUIRED FOR ASSEMBLING

If you have any questions regarding assembly or if you are missing parts, do not return this item to Retailer Store

Please call our customer service number and have your instructions and parts list ready to provide the model name, part name or factory number:
1-866-942-5362

Pacific Standard Time: 8:30 am - 4:30 pm Monday to Friday
or visit our web site 24 hours a day, 7 days a week for product assistance at
www.whalenfurniture.com

or e-mail your request to parts@whalenfurniture.com

MODEL No.: **PRO-5**
LOT No.: _____
DATE OF PURCHASE: _____



**THIS INSTRUCTION BOOKLET CONTAINS IMPORTANT SAFETY INFORMATION.
PLEASE READ AND KEEP FOR FUTURE REFERENCE.**

VAS Furniture Mfg., Inc.
Factory No. 33-10944
Page # 1

QUALITY GUARANTEE

We are confident that you will be delighted with your VAS Furniture purchase.

Should this product be defective in workmanship or materials or fail under normal use, we will repair or replace it for up to 1 year from date of purchase. Every VAS Furniture product is designed to meet your highest expectations. We guarantee that you will immediately see the value of our fine furniture.

This warranty gives you specific legal rights and you may also have other rights which vary from State to State.

Customer Service: 1-866-942-5362

8:30 a.m. - 4:30 p.m. PST Monday to Friday

www.whalenfurniture.com

MANUFACTURER: VAS FURNITURE

CATALOG: Flat Panel Console with Swinging Floater (PRO-5)

DATE OF MANUFACTURE: April, 2009

MADE IN CHINA

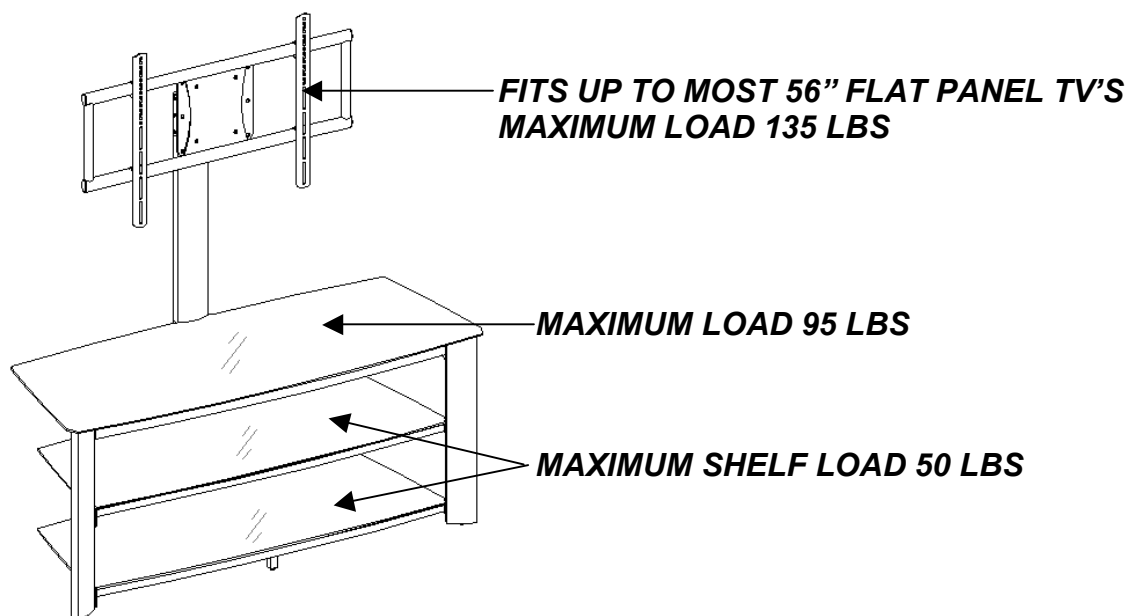

CAUTION:

This unit is intended for use only with the products and maximum weights indicated. Use with other products or products heavier than the maximum weights indicated may result in instability causing possible injury.

Notes: TV sets with base support should be placed squarely in the center of the stand with no overhanging on either side.

Please call for replacement parts or assistance: 1-866-942-5362

VAS Furniture Mfg., Inc.

Factory No. 33-10944

Page # 2

Parts List

Please read completely through the instructions and verify that all parts listed are present before beginning assembly.

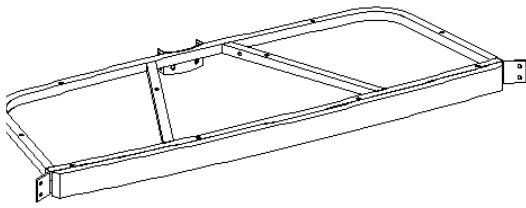

A- Top Shelf Frame (1)

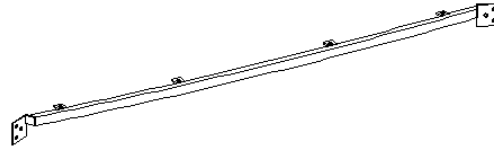

B- Middle Stretcher (1)

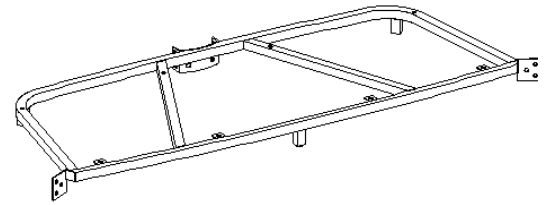

C- Bottom Shelf Frame (1)

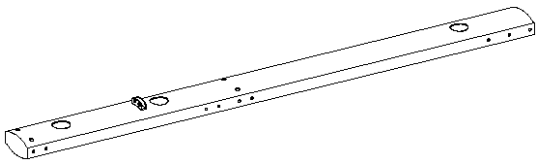

D- Spine (1)

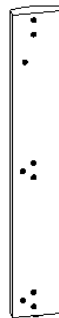

E- Left Leg (1)

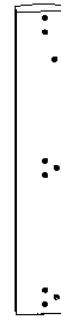

F- Right Leg (1)

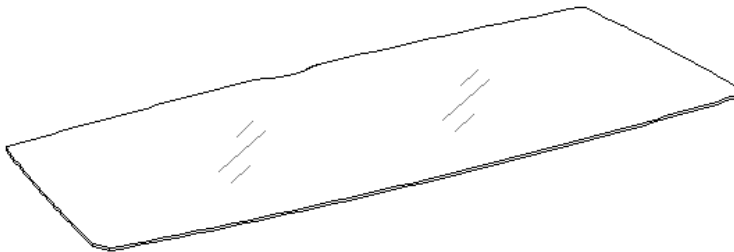

G- Top Glass (1)

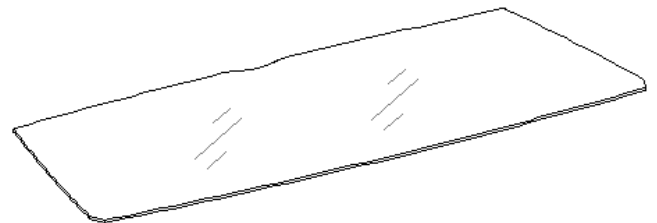

H- Glass Shelf (2)

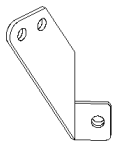

I- Front Left Support (1)

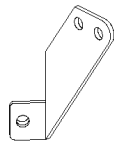

J- Front Right Support (1)

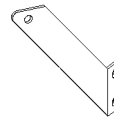

K- Back Left Support (1)

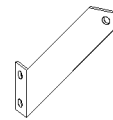

L- Back Right Support (1)

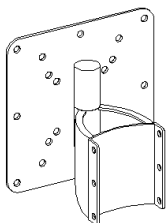

M- Deluxe Bracket with VESA Plate (1)

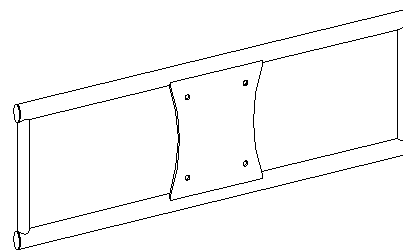

N- XYZ Mounting Frame (1)

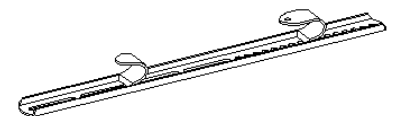

O- Monitor Bracket (2)

Please call for replacement parts or assistance: 1-866-942-5362

VAS Furniture Mfg., Inc.

Factory No. 33-10944

Page # 3

Hardware List

Please read completely through the instructions and verify that all parts listed are present before beginning assembly.

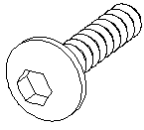

(1)- 5/8" Bolt (48+2 extra)

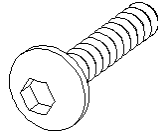

(2)- 3/4" Bolt (4+1 extra)



(3)- Lock Washer (50+2 extra)

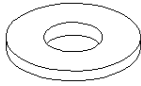

(4)- Flat Washer (46+2 extra)

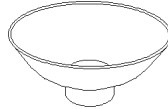

(5)-Suction Cup (22+1 extra)



(6)- Large Flat Washer (8+1 extra)



(7)- Nut (4+1 extra)

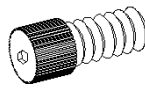

(8)- Set Screw (2pcs)



Open Wrench (1pcs)

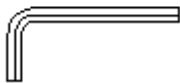

Allen Wrench (1)

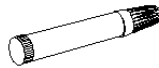

Touch Up Pen (1)

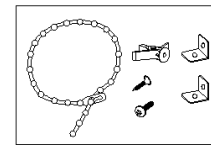

**Tipping Restraint Hardware Kit (1)
(Inside Plastic White Bag)**

TV Mounting Kit



M4 x 12 Bolt (4)



M4 x 30 Bolt (4)



M5 X 12 Bolt (4)

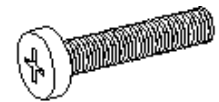

M5 x 30 Bolt (4)

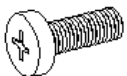

M6 x12 Bolt (4)

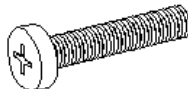

M6 x 35 Bolt (4)

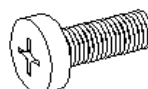

M8x16 Bolt (4)

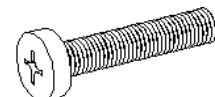

M8 x40 Bolt (4)



M4 Lock Washer (4)



M5 Lock Washer (4)



M6 Lock Washer (4)



M8 Lock Washer (4)



Large Spacer (4)



Small Spacer (4)

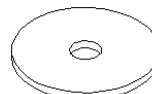

M4/M5 Flat Washer (8)

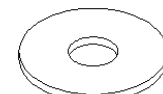

M6/M8 Flat Washer (4)

Please call for replacement parts or assistance: 1-866-942-5362

VAS Furniture Mfg., Inc.

Factory No. 33-10944

Page # 4

Tools Required: Allen Wrench (provided), Open Wrench (provided) and Phillips Screwdriver.

Assembly Instructions

Note: Please do not fully tighten all bolts until you finish assembling all parts, then go back and fully tighten all bolts, this will make it easier during assembly of unit.

1. Unpack the unit and confirm that you have all the hardware and required parts listed.
2. Locate the Spine (D) and set back face down on a scratch free surface as shown in detail #1.
3. Align the "U" shape plate holes of Top and Bottom Shelf Frames (A & C) with the threaded inserts on the Spine (D) in place, attach with 5/8" Bolts (1) and Lock Washers & Flat Washers (3 & 4), six bolts per shelf frame. See detail #1.

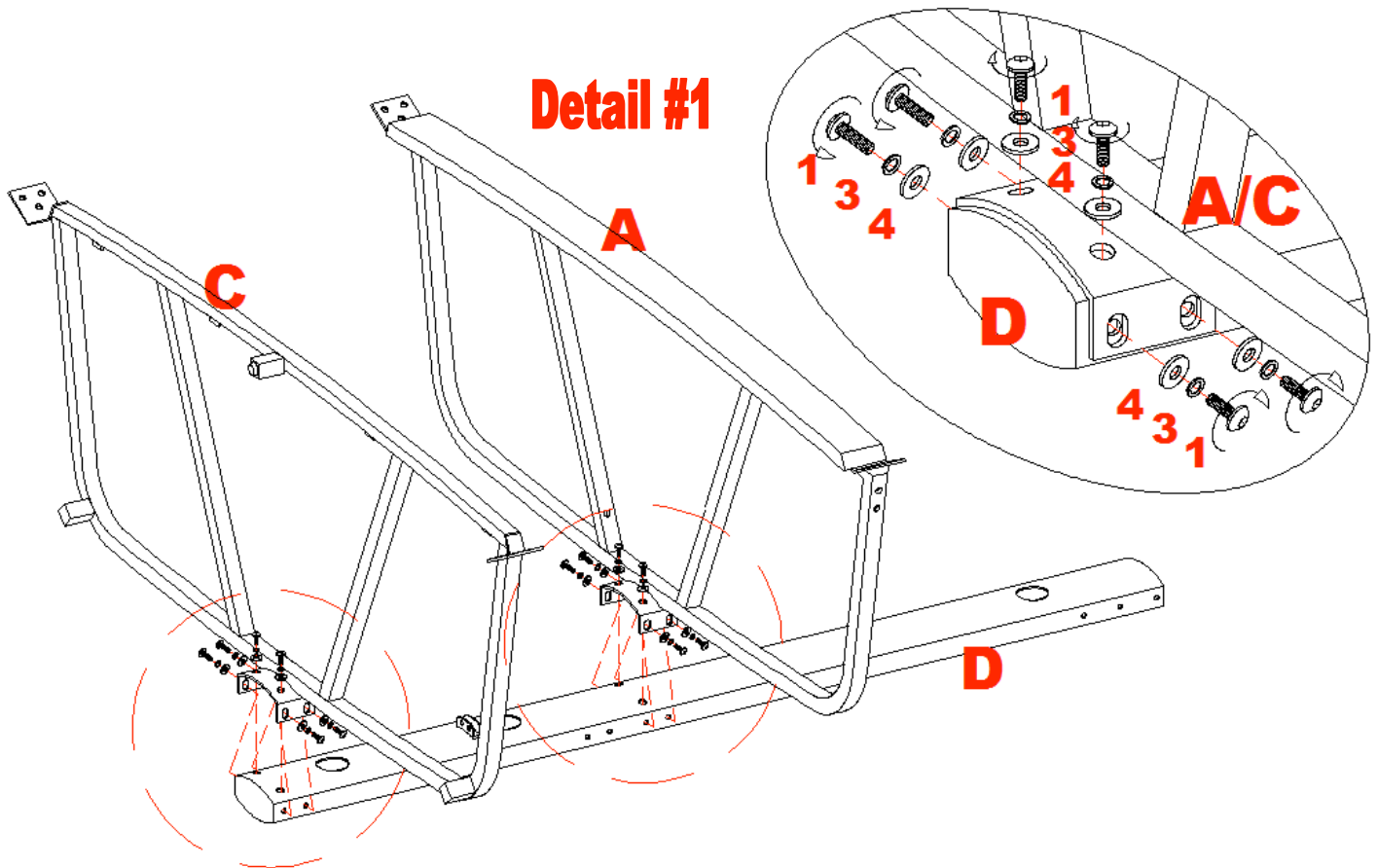

<u>Parts Provided</u>	<u>Qty</u>	<u>Tools Required</u>
A- Top Shelf Frame	(1)	Allen Wrench
C- Bottom Shelf Frame	(1)	
D- Spine	(1)	
(1) - 5/8" Bolt	(12)	
(3) - Lock Washer	(12)	
(4) - Flat Washer	(12)	

Please call for replacement parts or assistance: 1-866-942-5362

VAS Furniture Mfg., Inc.

Factory No. 33-10944

Page # 5

Assembly Instructions

- Attach Left Leg and Right Leg (E & F) to the Shelf Frames (A & C) using 5/8" Bolts (1) with Washers (3 & 4) through the end bracket holes as shown in detail #2. **DO NOT tighten the bolts.** Make sure the gap and offsets between the wooden front rail of Top Shelf Frame (A) and the Legs are the same. Loosen the bolts on the wooden front rail and adjust if necessary.
- Now align and attach the Middle Stretcher (B) between the Left and Right Leg (E & F) in place using six 5/8" Bolts (1) and Washers (3 & 4). See detail #2.

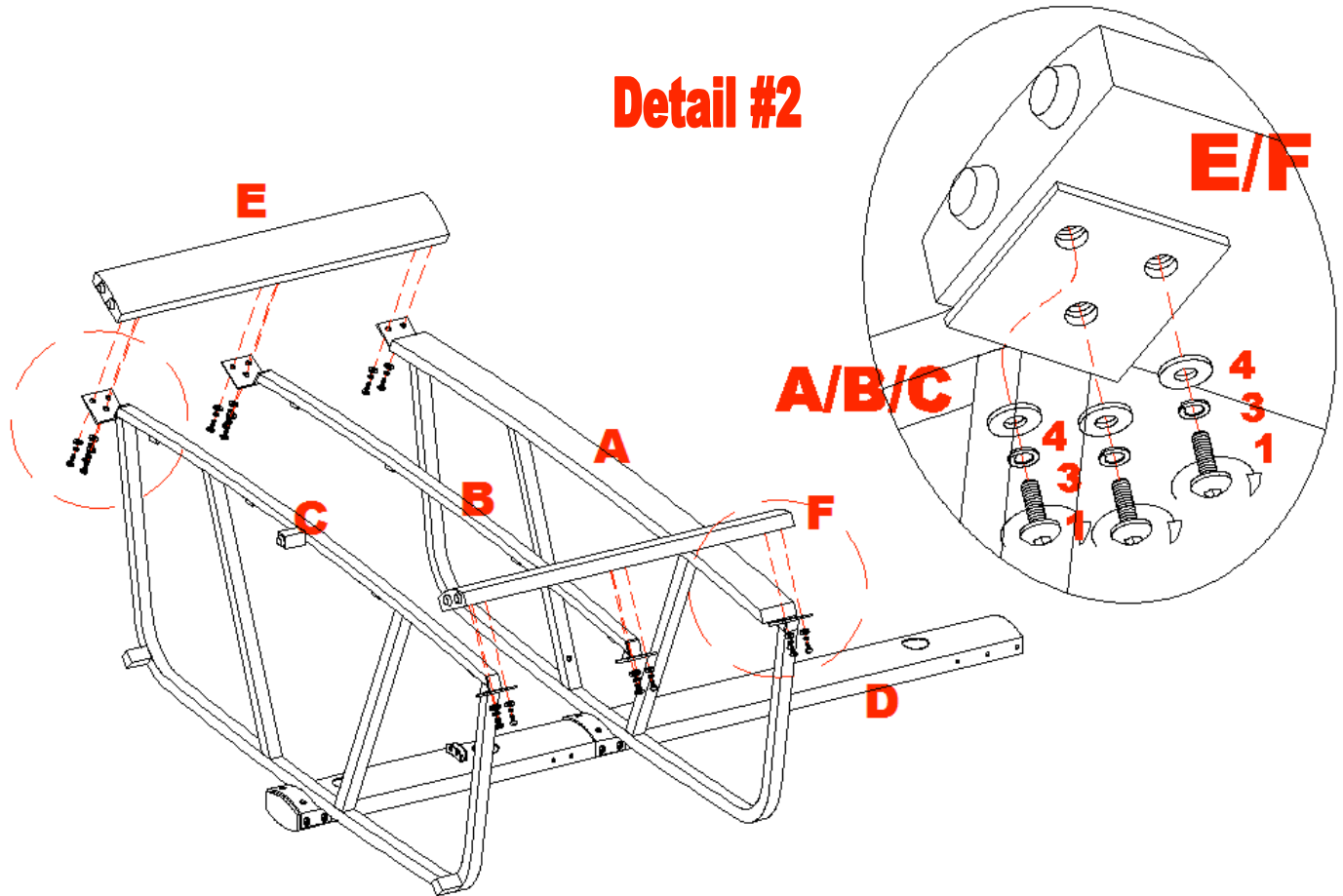

<u>Parts Provided</u>	<u>Qty</u>	<u>Tools Required</u>
B – Middle Stretcher	(1)	Allen Wrench
E –Left Leg	(1)	
F –Right Leg	(1)	
(1) - 5/8" Bolt	(16)	
(3) - Lock Washer	(16)	
(4) – Flat Washer	(16)	

Please call for replacement parts or assistance: 1-866-942-5362

VAS Furniture Mfg., Inc.

Factory No. 33-10944

Page # 6

Assembly Instructions

6. Stand the unit upright.
7. For a stable structure, align and attach the Front Left & Right Support (I & J) in place to connect the Top Shelf Frame (A) with both Legs (E & F) using 5/8" Bolts (1) with Washers (3 & 4), as shown in detail #3.
8. Align and attach the Back Left and Back Right Support (K & L) to the Top Shelf Frame (A) and Spine (D) with the 5/8" Bolts (1) with Washers (3 & 4), as shown in detail #3.

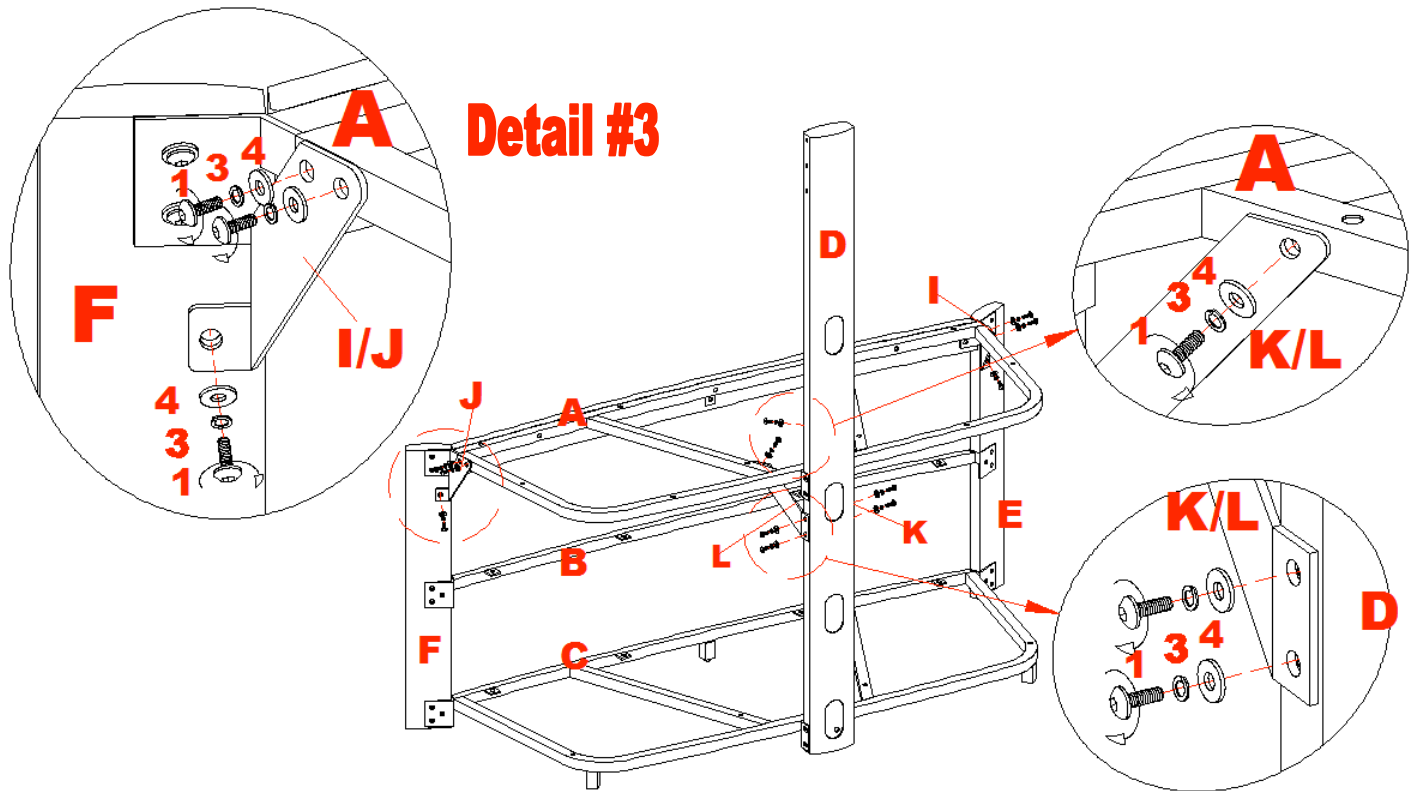

<u>Parts Required</u>	<u>Qty</u>	<u>Tools Required</u>
I- Front Left Support	(1)	<i>Allen Wrench</i>
J - Front Right Support	(1)	
K -Back Left Support	(1)	
L -Back Right Support	(1)	
(1) - 5/8" Bolt	(12)	
(3) -Lock Washer	(12)	
(4) -Flat Washer	(12)	

Please call for replacement parts or assistance: 1-866-942-5362

VAS Furniture Mfg., Inc.

Factory No. 33-10944

Page # 7

Assembly Instructions

- Go back and securely tighten all the bolts with Allen Wrench provided.
- In case of uneven floor, Floor Levelers are provided at the bottom of Legs (E & F) and front rail of Bottom Shelf Frame (C). Simply tilt the unit back and raise or lower floor leveler by hand to correct tilting. As shown in detail #4.

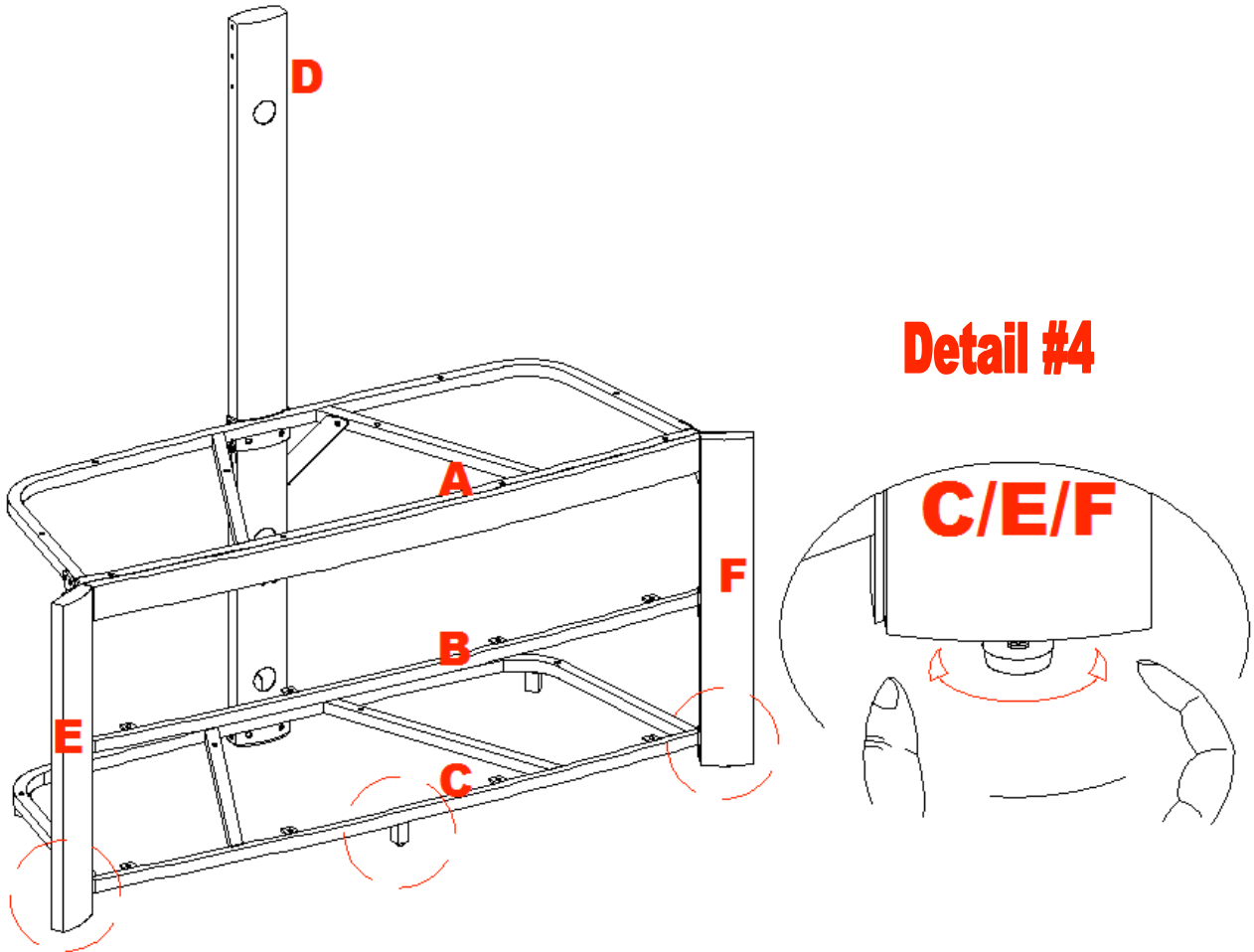

<u>Parts Required</u>	<u>Tools Required</u>
Pre-attached Floor Leveler	No tool required

Please call for replacement parts or assistance: 1-866-942-5362

VAS Furniture Mfg., Inc.

Factory No. 33-10944

Page # 8

Assembly Instructions to attach Deluxe Bracket w/ VESA Plate

11. Attach Deluxe Bracket with VESA Plate (M) to the top of Spine (D) using six 5/8" Bolts (1) with Lock Washers & Flat Washers (3 & 4) as shown in detail #5.

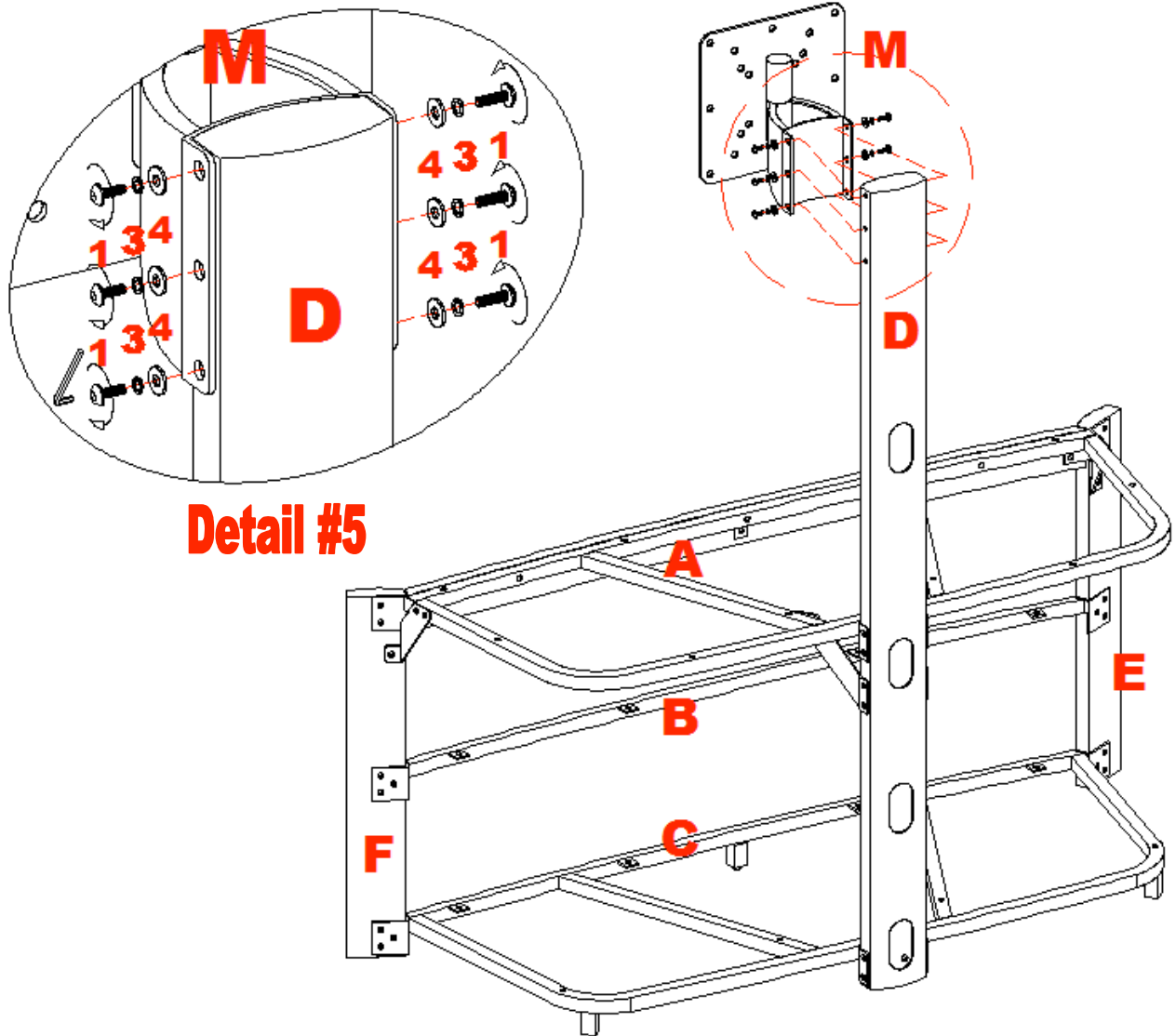

<u>Parts Required</u>	<u>Qty</u>	<u>Tools Required</u>
M – Deluxe Bracket with VESA Plate	(1)	Allen Wrench
(1) – 5/8" Bolt	(6)	
(3) - Lock Washer	(6)	
(4) – Flat Washer	(6)	

Please call for replacement parts or assistance: 1-866-942-5362

Assembly Instructions

Note: There are two mounting options included in this swinging floater TV console:
1. VESA Plate;
2. XYZ Mounting Frame to accommodate random hole patterns.

12. For LCD 32" or smaller you can mount your LCD directly to the Deluxe Bracket with VESA Plate (M), using the appropriate Bolts through the Lock Washers and Flat Washers through the proper holes of VESA Plate and then into the TV. See detail #6.

Note: Hand threading the bolt in the TV Mounting Kit included into the threaded insert on the back of the TV to determine correct size bolt you will require. If you are unable to find the correct one, consult a local hardware store.

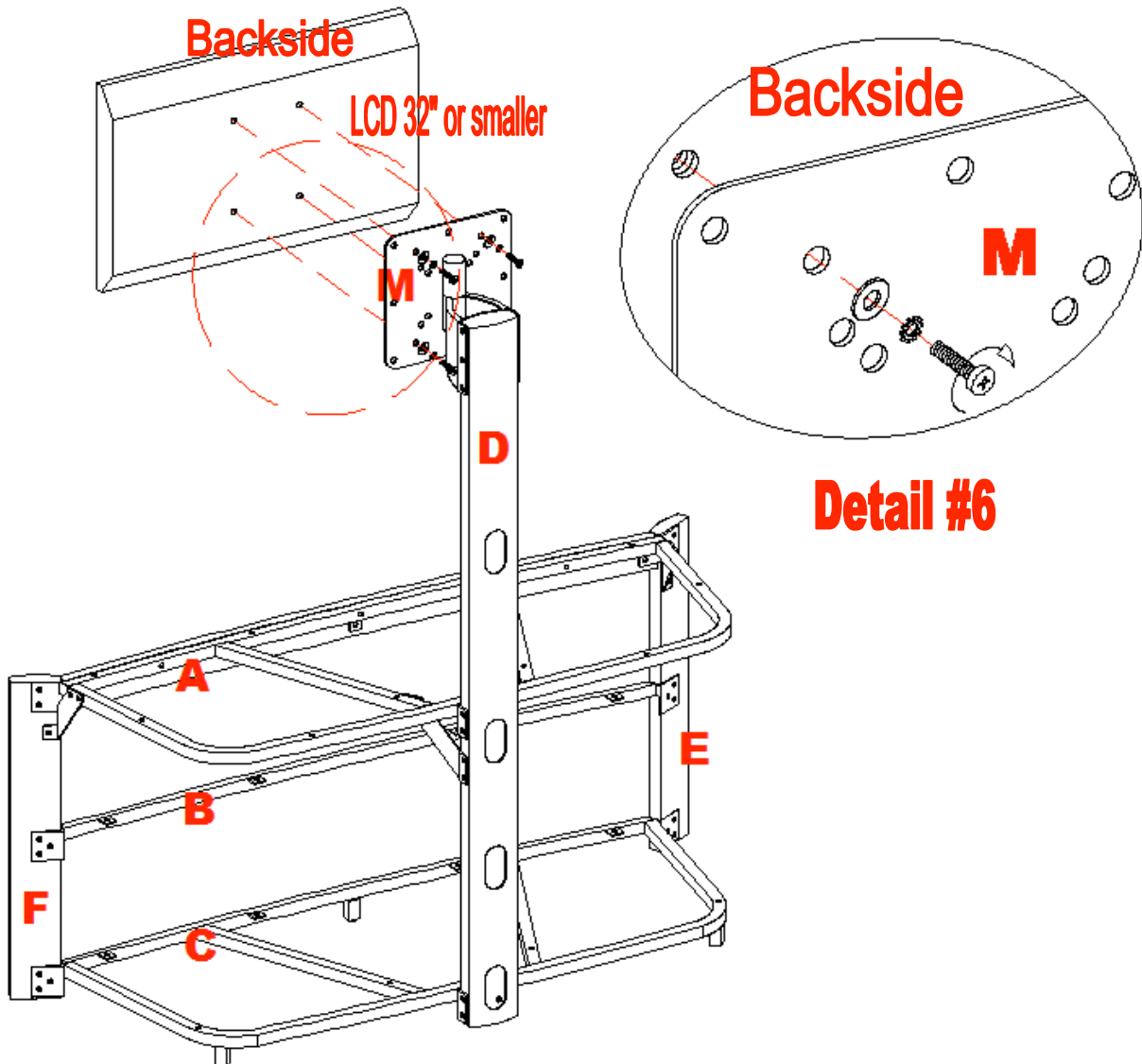

Parts Required

See TV Mounting Kit

Tools Required

Phillips Screwdriver

~~Please call for replacement parts or assistance: 1-866-942-5362~~

VAS Furniture Mfg., Inc.

Factory No. 33-10944

Page # 10

Assembly Instructions

Note: For Plasma and LCD TVs larger than 32", you must use the XYZ Mounting Frame (N) provided. The XYZ Mounting Frame will accommodate large LCD without VESA Hole Patterns and Plasma TV's with Random Hole Patterns.

13. Attach XYZ Mounting Frame (N) to the Deluxe Bracket with VESA Plate (M), using 3/4" Bolts (2) with Large Flat Washers (6) through the mounting plate and appropriate hole set on VESA Plate, through the other Large Flat Washers (6) and Lock Washers (3) then secure with Nut (7), as shown in detail #7.

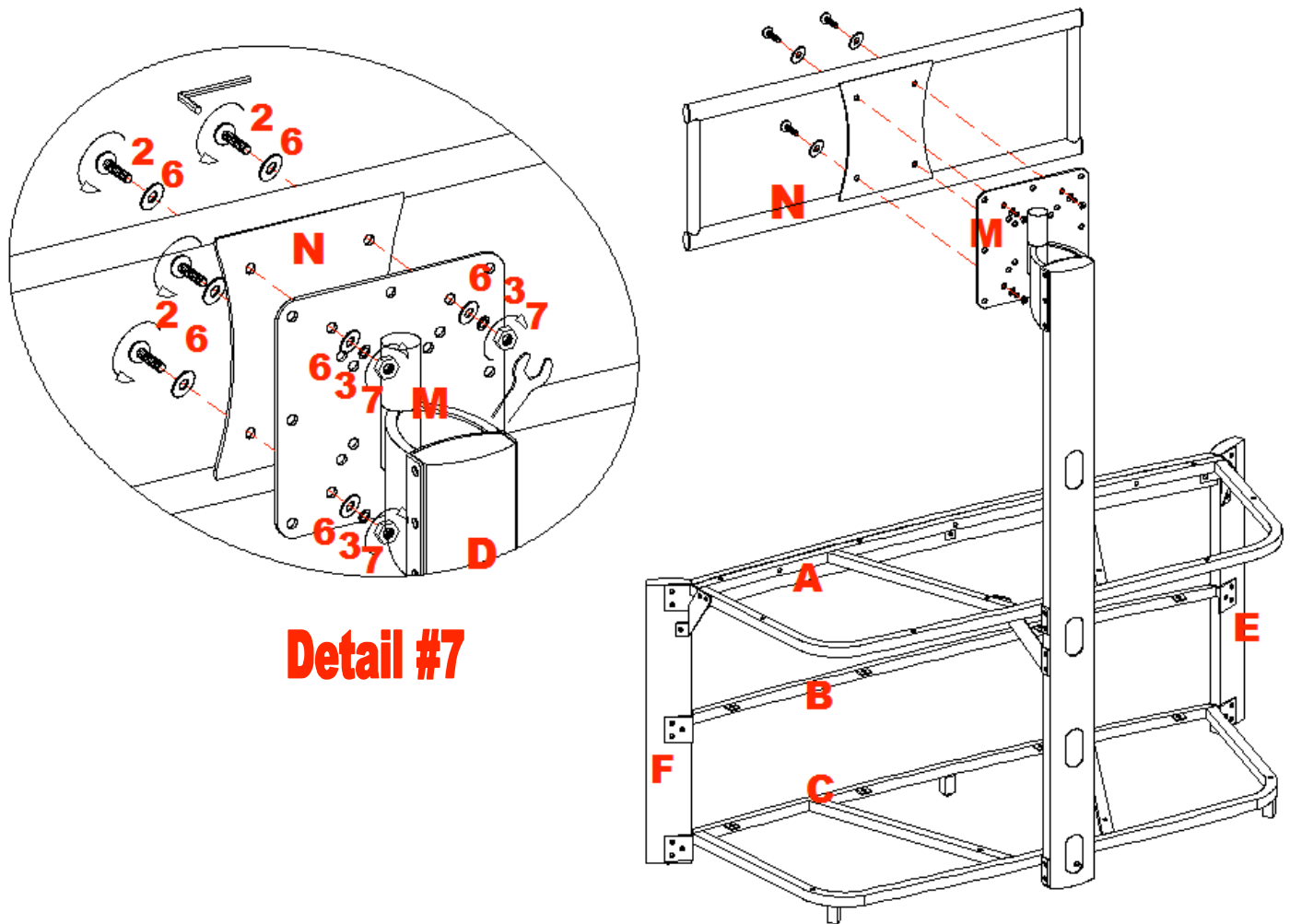

Detail #7

<u>Parts Provided</u>	<u>Qty</u>	<u>Tools Required</u>
N – XYZ Mounting Frame	(1)	Allen Wrench
(2) – 3/4" Bolt	(4)	Open Wrench
(3)– Lock Washer	(4)	
(6) – Flat Washer	(8)	
(7) – Nut	(4)	

Please call for replacement parts or assistance: 1-866-942-5362

VAS Furniture Mfg., Inc.

Factory No. 33-10944

Page # 11

Mounting Monitor Bracket to a television with a flat back

Note: For televisions with a curved back or recessed back proceed directly to step #17.

14. Please refer to detail #8 & 8A to determine the correct size bolt your TV requires by several try. If you are unable to find the correct bolt, consult a local hardware store.
15. Once you have determined the correct diameter Bolt, please follow the appropriate Diagram below; Insert the selected short Bolt with Washers into the upper holes of TV. As shown in detail #8A.

Note: Lean the TV up against a wall or other solid surface when attaching with the Monitor Brackets (O). DO NOT place the TV face down on the glass this may cause permanent damage.

16. Proceed to insert the selected longer Bolt with Washers and Spacer into the bottom holes of TV as shown in detail #8. Make sure the Monitor Brackets (O) are centered and level with each other. Tighten the bolts securing the Monitor Brackets (O) to the TV.

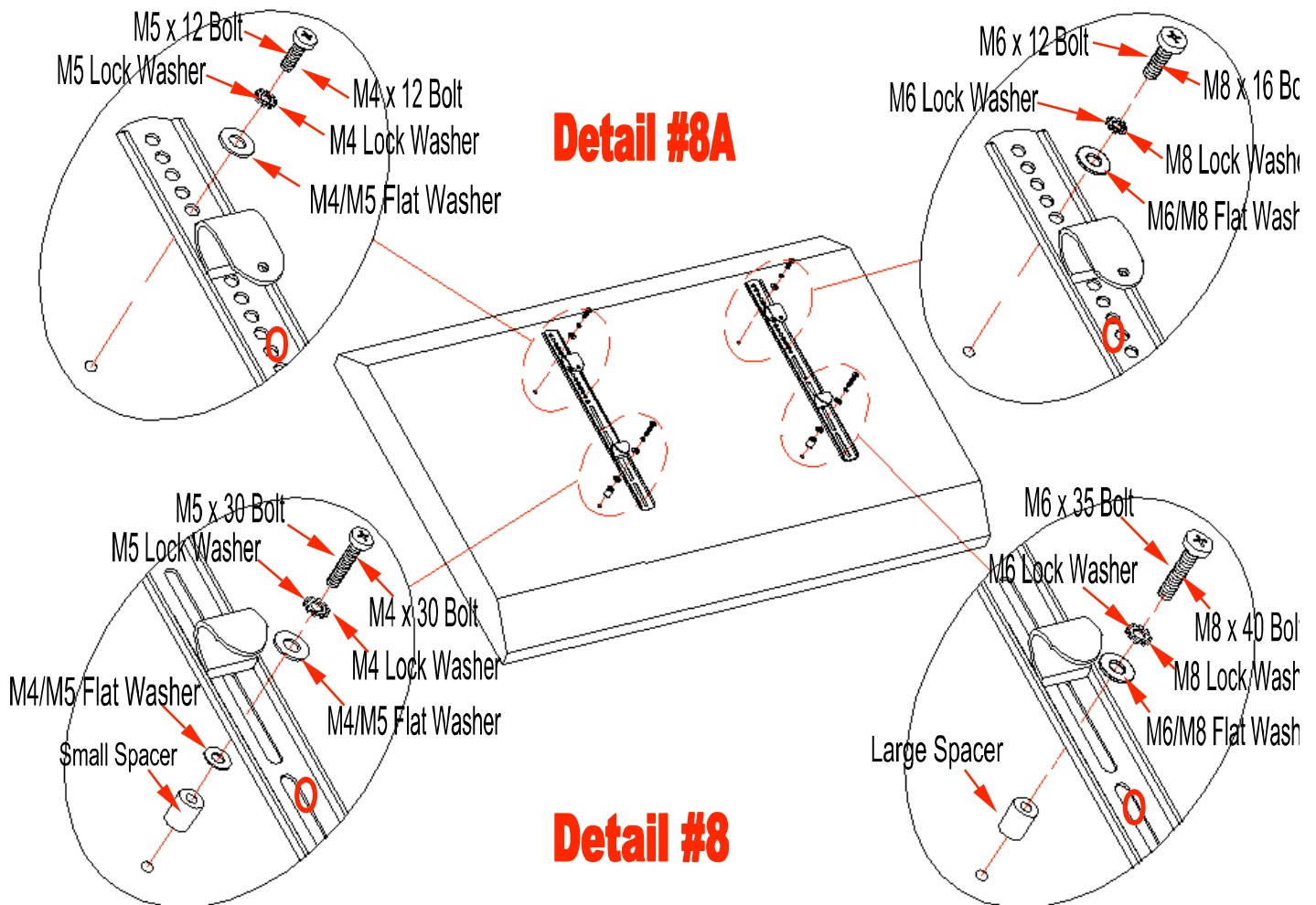

Please call for replacement parts or assistance: 1-866-942-5362

VAS Furniture Mfg., Inc.

Factory No. 33-10944

Page # 12

Mounting Monitor Bracket to a television with a curved / recess back

17. Please refer to detail #9 to determine the correct size bolt your TV requires by several try. If you are unable to find the correct bolt consult a local hardware store.
18. Once you have determined the correct size of Bolt, please follow the appropriate Diagram below, and insert the longer bolt with appropriate Washers & Spacer as shown in detail #9.

⚠ WARNING: DO NOT LAY THE TELEVISION FACE DOWN ON THE GLASS

19. Make sure the Monitor Brackets (O) are vertically centered and level with each other. Tighten the bolts securing the Monitor Brackets (O) to the TV.

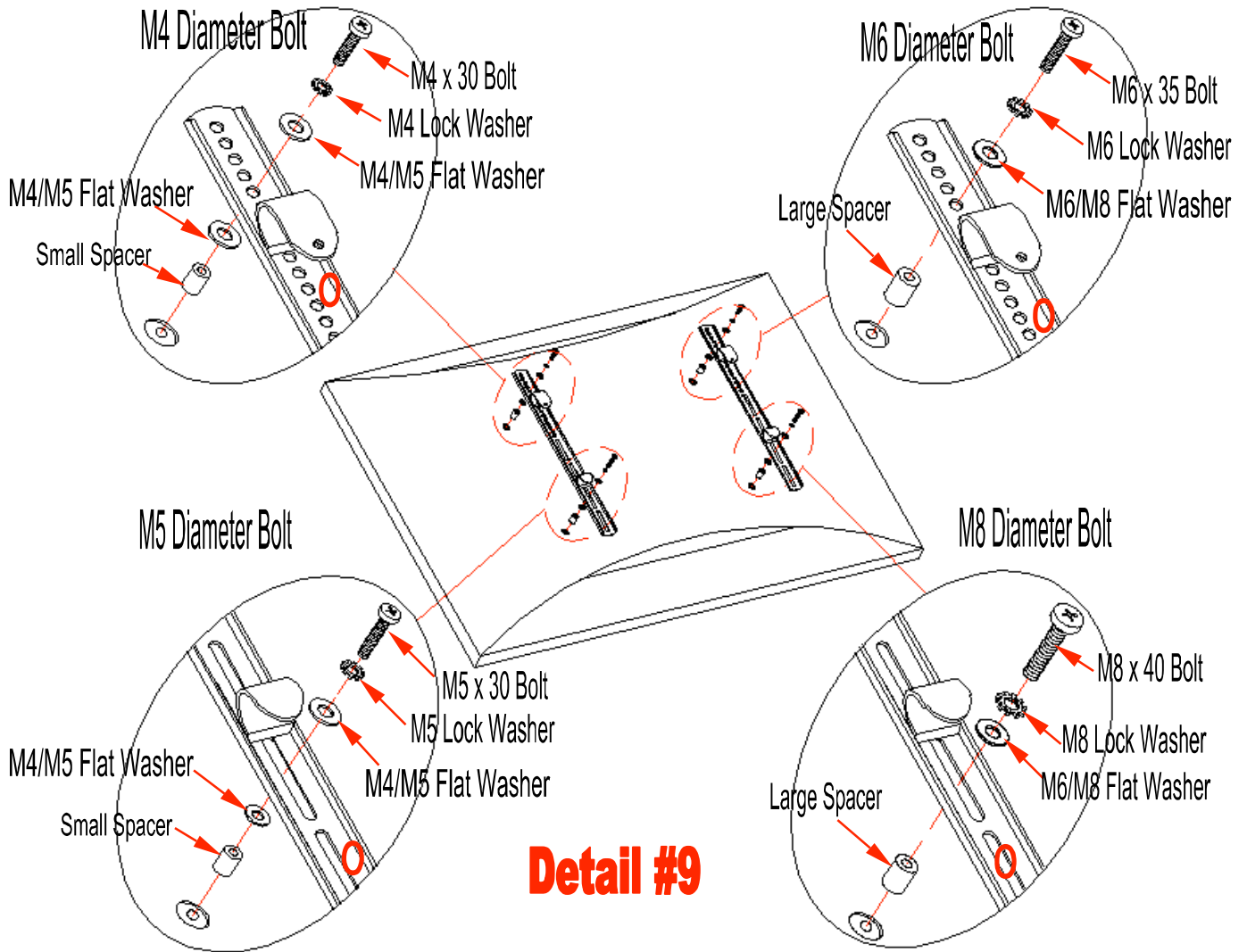

<u>Parts Provided</u>	<u>Qty</u>	<u>Tools Required</u>
O – Monitor Bracket TV Mounting Kit	(2)	Phillips Screwdriver

Please call for replacement parts or assistance: 1-866-942-5362

Assembly Instructions

20. Now you can hang your Plasma onto the XYZ Mounting Frame (N). For additional safety please screw two 5/8" Bolts (1) into the upper hooks of Monitor Brackets (O) to prevent TV from falling. See detail #10.

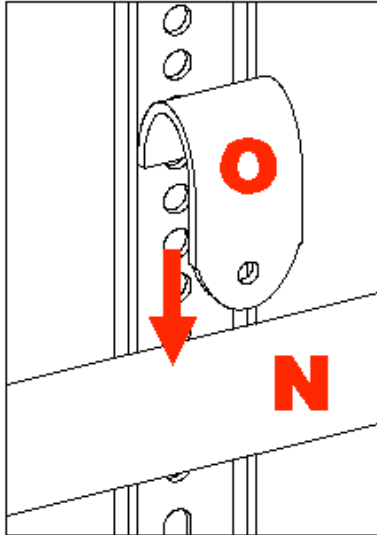

↓ Detail #10

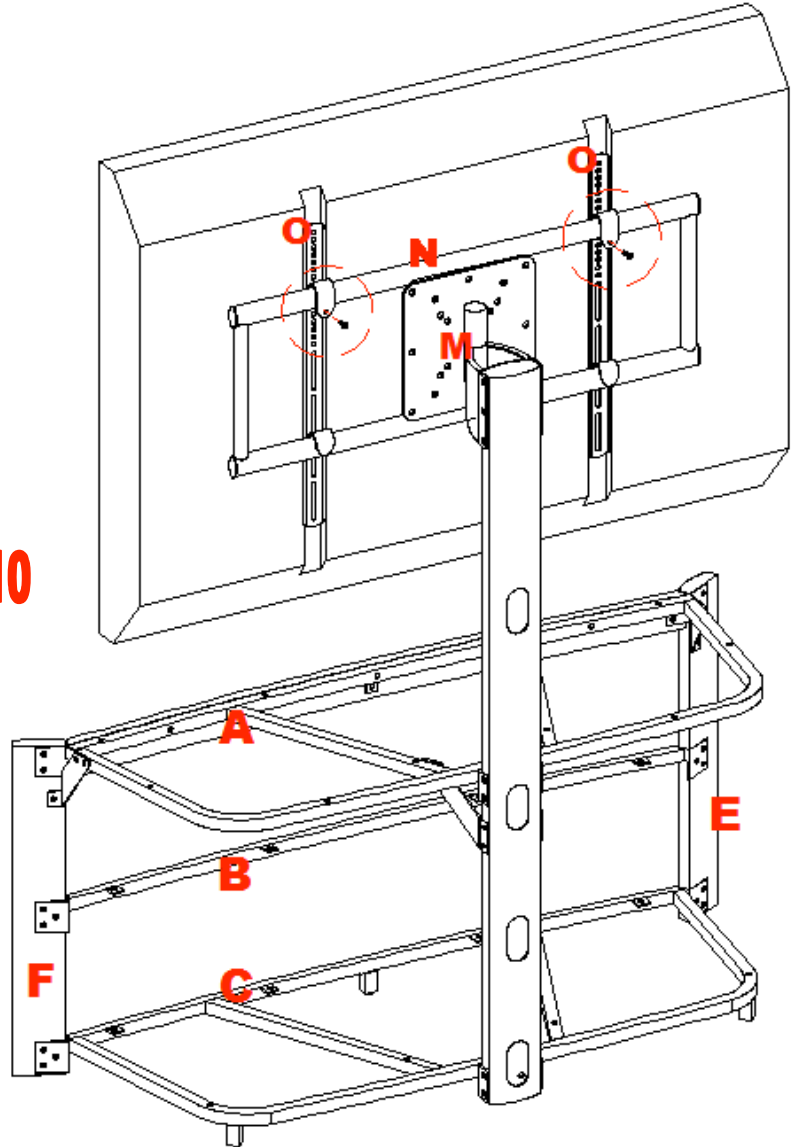
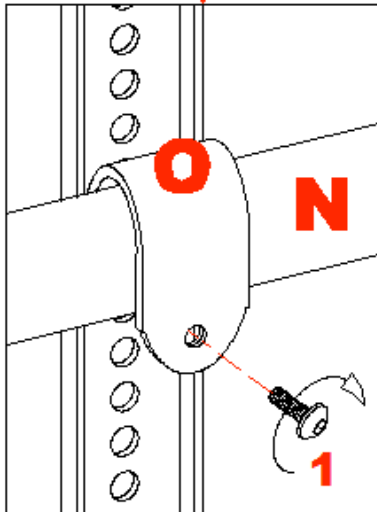

<u>Parts Provided</u>	<u>Qty</u>	<u>Tools Required</u>
(1) – 5/8" Bolt	(2)	Allen Wrench

Please call for replacement parts or assistance: 1-866-942-5362

VAS Furniture Mfg., Inc.

Factory No. 33-10944

Page # 14

Assembly Instructions

21. Insert the Suction Cups (5) into the top holes of Top & Bottom Shelf Frames (A & C) and Middle Stretcher (B). Make sure they go all the way in. See detail #11.
22. Insert the Top Glass & Glass Shelves (G & H) in place. Make sure the Glass Shelf sits correctly and goes all the way against the Spine to prevent falling easily and getting damage. Once the Middle Glass Shelf (with plastic filler over the back curve) is inserted all the way into the "U" shape Glass Clip on the Spine, screw two Set Screws (8) into the Glass Clip to secure the shelf in place. See detail #11.

Note: If glass is scratched you can repair by using a BLACK marker and filling in scratched area from underneath.

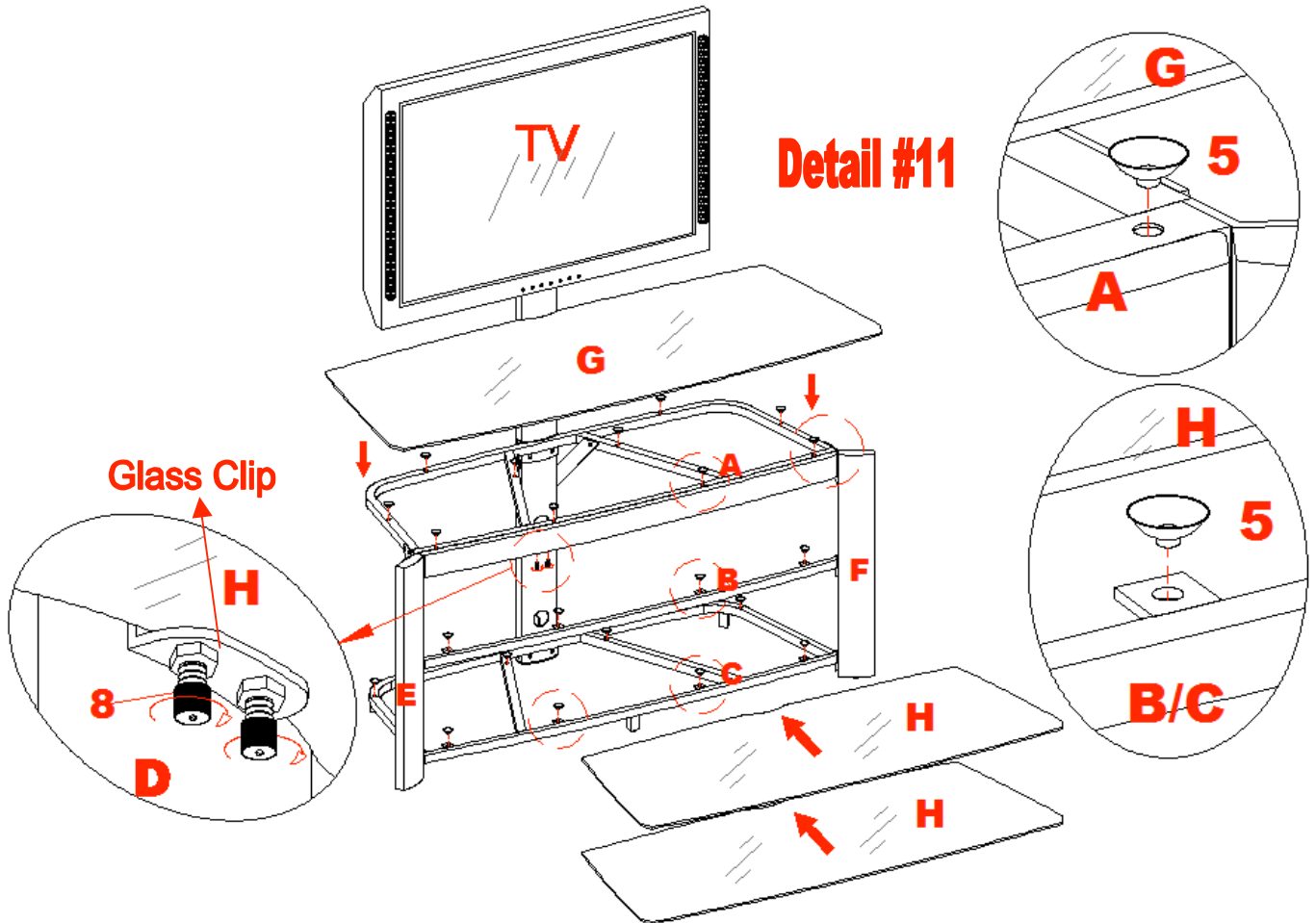

<u>Parts Provided</u>	<u>Qty</u>	<u>Tools Required</u>
G- Top Glass	(1)	No Tool Required
H- Glass Shelf	(2)	
(5)- Suction Cup	(22)	
(8)- Set Screw	(2)	

Please call for replacement parts or assistance: 1-866-942-5362

VAS Furniture Mfg., Inc.

Factory No. 33-10944

Page # 15

TIPPING RESTRAINT HARDWARE

Note: We have included one Tipping Restraint Hardware bag for this Unit.

When properly installed, this restraint can provide protection against the unexpected tipping of the Unit due to small tremors, bumps or climbing. We strongly recommend mounting this hardware to a wall stud and your Unit when assembling and using your console.

Please carefully read the instructions printed on the plastic white bag.

Note: You must install the Tipping Restraint Hardware with the unit in use to prevent any accidents or damage to the unit.

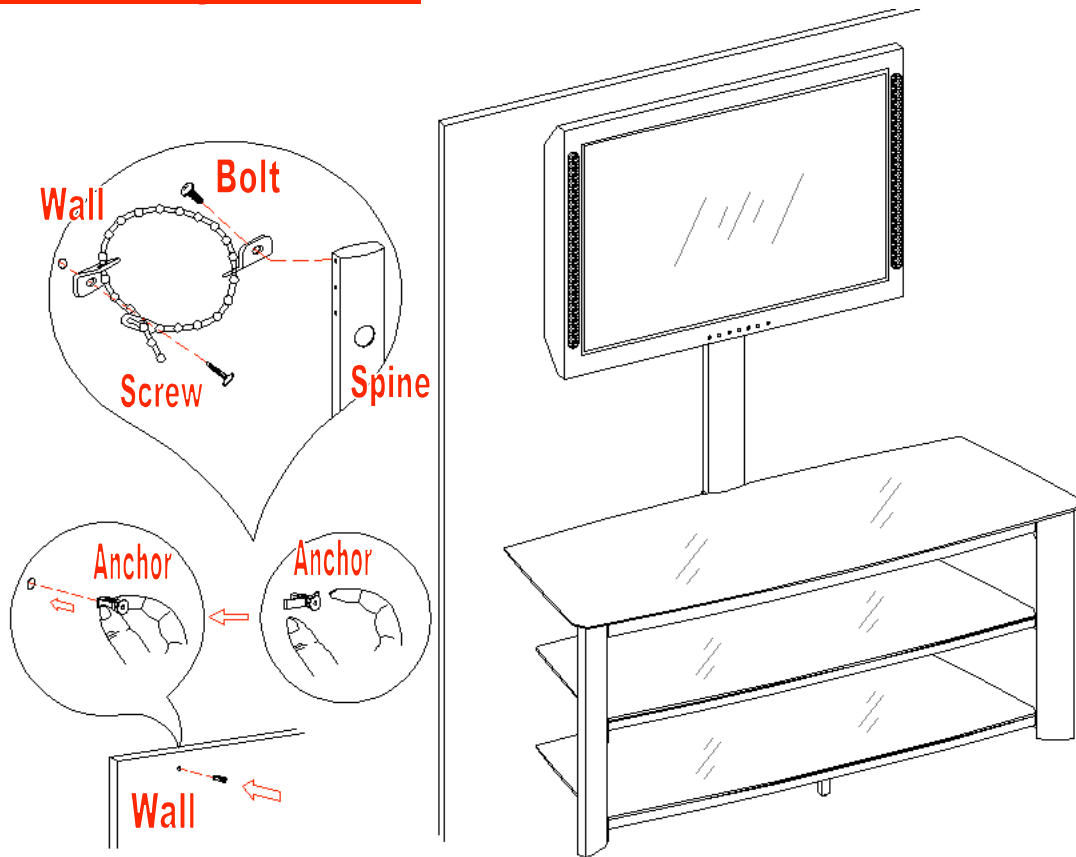

Tools Required: Allen Wrench (provided), Phillips Screwdriver, Mallet, Power Drill, and 3/8" Drill Bit.

A Touch-Up Pen has been provided to repair any small nicks or scratches that may occur during assembly or shipping.

Your assembly should now be complete.
Thank you for your purchase.



Please call for replacement when value and style matter. Phone: 1-866-942-5362

VAS Furniture Mfg., Inc.

Factory No. 33-10944

Page # 16

IF YOU REQUIRED TO ORDER PARTS PLEASE USE THE LIST BELOW

Flat Panel Console with Swinging Floater (PRO-5)

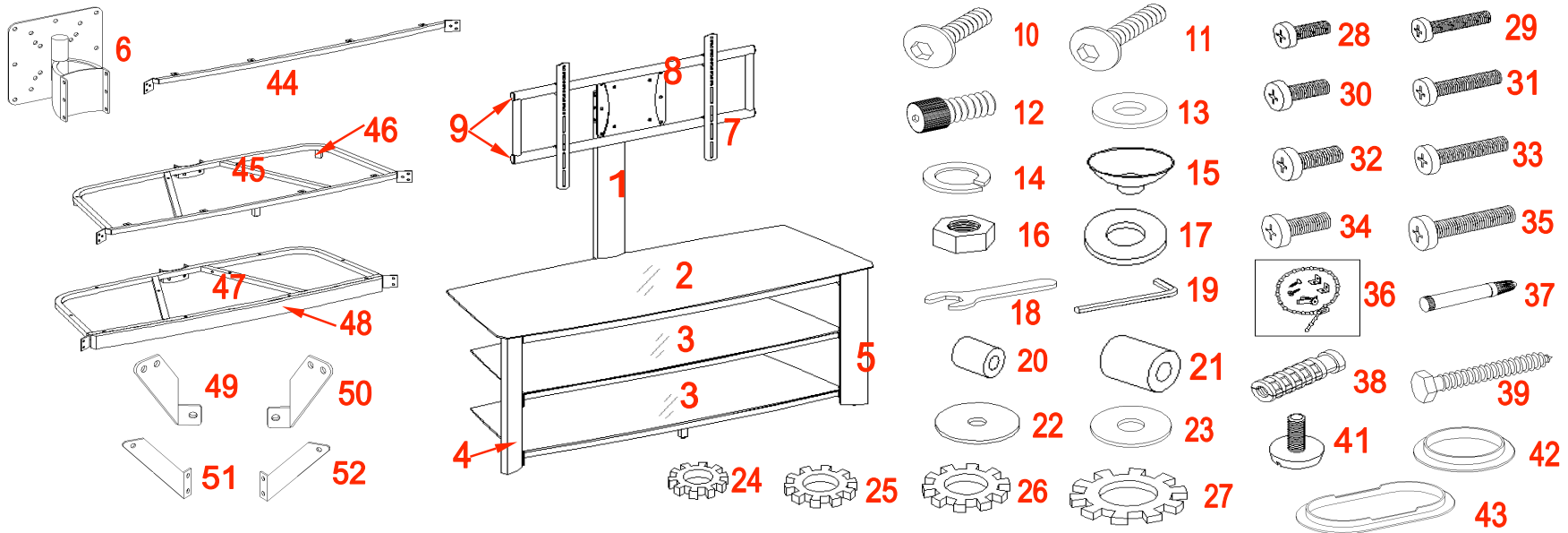

- *PRO-5-1-S
- *PRO-5-2-TG
- *PRO-5-3-GS
- *PRO-5-4-LL
- *PRO-5-5-RL
- *PRO-5-6-DBWP
- *PRO-5-7-MB
- *PRO-5-8-MF
- *PRO-5-9-PC
- *PRO-5-10-5/8B
- *PRO-5-11-3/4B
- *PRO-5-12-SS
- *PRO-5-13-SFW
- *PRO-5-14-LW
- *PRO-5-15-SC
- *PRO-5-16-N
- *PRO-5-17-LFW
- *PRO-5-18-OW
- *PRO-5-19-AW
- *PRO-5-20-SS
- *PRO-5-21-LS
- *PRO-5-22-M4M5FW
- *PRO-5-23-M6M8FW
- *PRO-5-24-M4LW
- *PRO-5-25-M5LW
- *PRO-5-26-M6LW

- Spine
- Top Glass
- Glass Shelf
- Left Leg
- Right Leg
- Deluxe Bracket w/VESA Plate
- Monitor Bracket
- Mounting Frame
- Plastic Cover
- 5/8" Bolt
- 3/4" Bolt
- Set Screw
- Small Flat Washer
- Lock Washer
- Suction Cup
- Nut
- Large Flat Washer
- Open Wrench
- Allen Wrench
- Small Spacer
- Large Spacer
- M4/M5 Flat Washer (for TV mounting)
- M6/M8 Flat Washer (for TV mounting)
- M4 Lock Washer
- M5 Lock Washer
- M6 Lock Washer

- *PRO-5-27-M8LW
- *PRO-5-28-M4x12B
- *PRO-5-29-M4x30B
- *PRO-5-30-M5x12B
- *PRO-5-31-M5x30B
- *PRO-5-32-M6x12B
- *PRO-5-33-M6x35B
- *PRO-5-34-M8x16B
- *PRO-5-35-M8x40B
- *PRO-5-36-TRHK
- *PRO-5-37-TUP
- *PRO-5-38-1 3/4CA
- *PRO-5-39-2 1/2LB
- *PRO-5-40-CH
- *PRO-5-41-FL
- *PRO-5-42-RPG
- *PRO-5-43-OPG
- *PRO-5-44-MS
- *PRO-5-45-BSF
- *PRO-5-46-PEC
- *PRO-5-47-TSF
- *PRO-5-48-WFR
- *PRO-5-49-FLS
- *PRO-5-50-FRS
- *PRO-5-51-BLS
- *PRO-5-52-BRS

- M8 Lock Washer
- M4 x 12 Bolt
- M4 x 30 Bolt
- M5 X 12 Bolt
- M5 x 30 Bolt
- M6 x 12 Bolt
- M6 x 35 Bolt
- M8 X 16 Bolt
- M8 x 40 Bolt
- Tipping Restraint Hardware Kit
- Touch Up Pen
- 1 3/4" Concrete Anchor
- 2 1/2" Lag Bolt
- Complete Hardware
- Floor Leveler
- Round Plastic Grommet
- Oval Plastic Grommet
- Middle Stretcher
- Bottom Shelf Frame
- Plastic End Cap
- Top Shelf Frame
- Wooden Front Rail
- Front Left Support
- Front Right Support
- Back Left Support
- Back Right Support