

SEARS

**OWNERS
MANUAL**

**MODEL NO.
646.106990**

CAUTION:
*Read Rules for
Safe Operation
and Instructions
Carefully*

CARTON CONTENTS:
Buffer/Polisher
2 8-oz. Bonnets
2-oz. Wax
2-fl. oz. Cleaner/Glaze

**SAVE THIS
MANUAL FOR
FUTURE REFERENCE**

CRAFTSMAN®

BUFFER/POLISHER SYSTEM

DOUBLE INSULATED

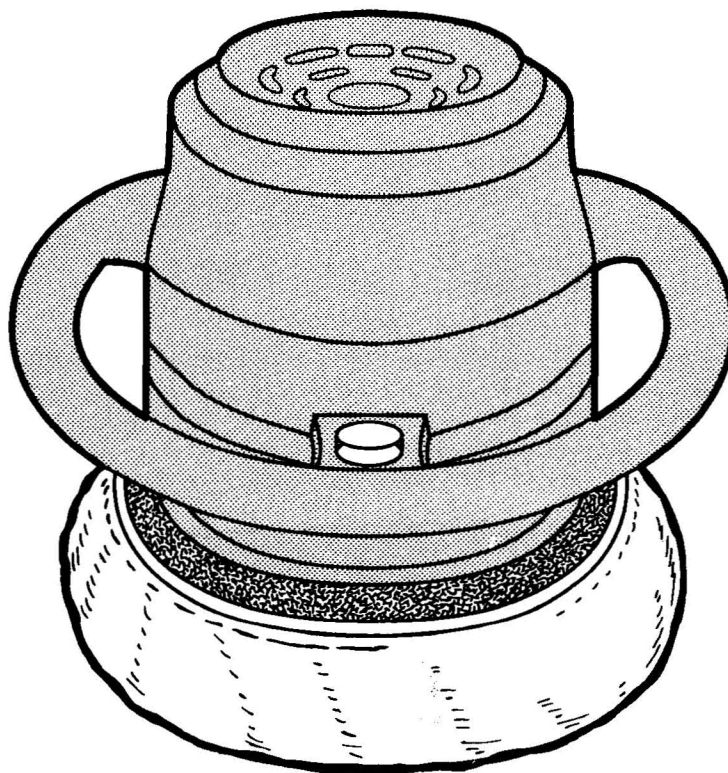

**Introduction
Operation
Maintenance
Repair Parts**



Sold by SEARS ROEBUCK AND CO., Chicago, IL 60684 U.S.A.

WAXING SYSTEM INSTRUCTIONS

Before you begin, make sure your car is clean and dry. The work area should be dry also.

1. Place clean bonnet securely on pad as shown (A).
2. Spread about a heaping teaspoonful of wax evenly over the entire surface of the bonnet (B).
3. Apply about twice that quantity of Cleaner/Glaze over wax on bonnet (C). **DO NOT APPLY DIRECTLY TO CAR.** This first application should do 1/3 of the car. For the second and third applications of wax and cleaner/glaze, use half the quantity stated above. Bonnet will not absorb as much when reloading.
4. **Always start and stop polisher on or against the car surface (D).**
Hold extension cord over shoulder and do flat surfaces first - hood, trunk and roof. Cover areas quickly with broad, sweeping strokes in a criss-cross pattern. Do not press down on polisher. The machine's action, not pressure, does the best job.
5. After flat surfaces are covered with wax and cleaner/glaze, do sides of car (E). If necessary, remove road tar with a general cleaner before polishing. Also, remove excess grease spots, bug stains, etc. Hold polisher as shown. Let cord hang free. It is not necessary to use criss-cross motion on doors and fenders.
6. Finally, remove bonnet (F) and hand polish all hard-to-reach surfaces; under the bumpers, around the door handles, etc. (G)
7. Put a clean bonnet on the polisher (H). Remove chemicals in the same order they were applied. Use long, sweeping strokes in a criss-cross pattern. Do not press hard. Let the polisher do the work (I).

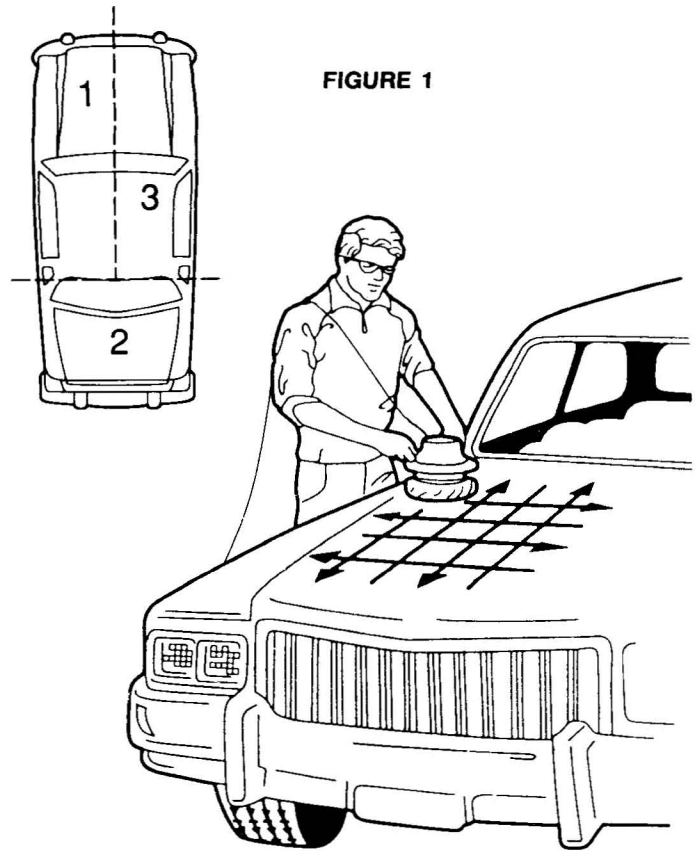
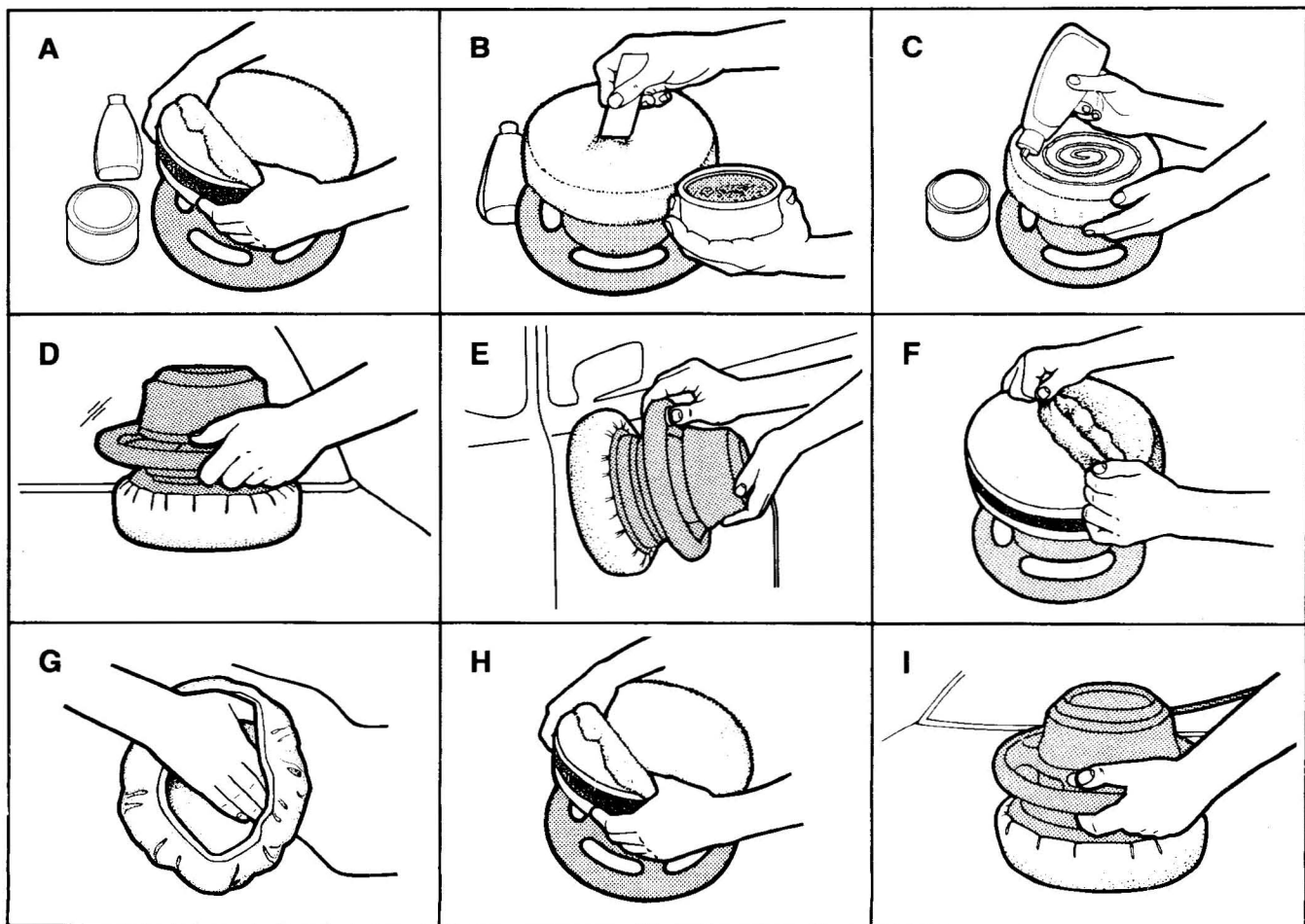

FIGURE 1





START BY READING THESE IMPORTANT SAFETY RULES

OPERATE THE BUFFER/POLISHER ONLY IN A DRY AREA. RUBBER FOOTWEAR IS RECOMMENDED WHEN WORKING OUTDOORS.

REPAIR OR REPLACE DAMAGED CORDS. EXTENSION CORDS ARE AVAILABLE AT LOCAL SEARS STORES. DO NOT PUT FINGERS, OBJECTS OR TOOLS BETWEEN THE GUARD AND THE PAD HOLDER WHILE MACHINE IS RUNNING.

KEEP CHILDREN AT A SAFE DISTANCE FROM THE WORK AREA.

AVOID ACCIDENTAL STARTING. KEEP FINGERS AWAY FROM SWITCH WHEN CARRYING PLUGGED-IN POLISHER.

ALWAYS WEAR EYE PROTECTION AND PROPER CLOTHING (NOT LOOSE OR BULKY). DO NOT WEAR LOOSE JEWELRY.

DOUBLE INSULATION - SAFETY PLUS...

Double insulation construction and shock proof housing to assure protection from electrical shock with an extra layer of electrical insulation plus the primary insulation system. Even if the primary system fails, the secondary barrier protects you. Double insulated tools do not require three-wire grounding. This tool is equipped with a two prong plug and does not require a grounding adapter.

CARE AND MAINTENANCE OF YOUR POLISHER

1. Bonnets can be machine-washed in cold water with a small amount of detergent on a few minute cycle; then machine-dried at medium heat. **HOWEVER**, hand washing and air drying is recommended for longer bonnet life.
2. To prolong pad life and shape, store polisher with pad face up.
3. Remove bonnet from pad when polisher is not in use so that pad can dry out and retain its original shape.
4. Grip the polisher firmly but without downward pressure. Pressing too hard will slow down the machine's movement and affect the quality of the work.
5. The sample-size chemicals included with your polisher will easily do a large car. Badly oxidized paint may require several applications. (Refer to Accessories on back cover for larger size replacement chemicals).
6. The most common error, however, is applying too much wax and cleaner/glaze. If pad absorbs too much chemical, it will not last as long. **AND POLISHING IS MORE DIFFICULT AND TAKES LONGER.**
7. If bonnet continually comes off pad, you may be using too much wax and cleaner/glaze.
8. If wax seems difficult to buff, you may have used too much wax.
9. Use only mild soap and a damp sponge to clean polisher. Do not immerse any part in liquid. If polisher needs repair, use only identical replacement parts illustrated and listed on Page 4.

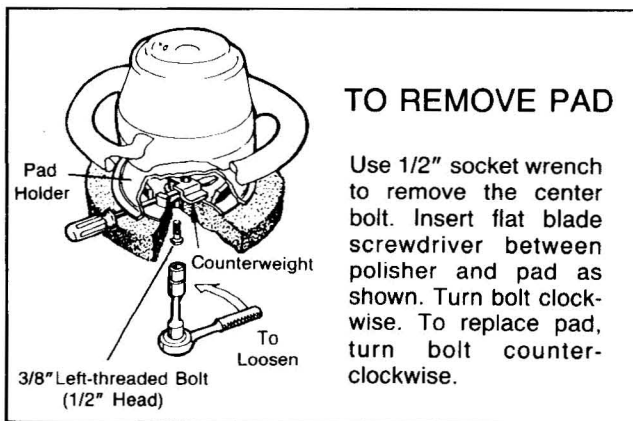

Motor RPM.....	3100 @ 120V (Bench Speed)
Oscillations per minute.....	2400 (no load)
AMPS.....	.65 (Working Load)
Weight.....	5 lb. 6 oz.

FULL ONE YEAR WARRANTY ON CRAFTSMAN BUFFER/POLISHER

If this Craftsman Buffer/Polisher fails to give complete satisfaction within one year from the date of purchase, RETURN IT TO THE NEAREST SEARS STORE THROUGHOUT THE UNITED STATES and Sears will repair it free of charge.

If this Buffer/Polisher is used for commercial or rental purposes, this warranty applies for only 90 days from date of purchase.

This warranty gives you specific legal rights, and you may also have other rights which vary from state to state.

SEARS ROEBUCK AND CO., Dept. 698/731A, Sears Tower, Chicago, IL 60684

NOTE: FOAM SPONGE RUBBER PAD IS NOT INCLUDED IN THE WARRANTY. IT IS A REPLACEMENT ITEM.

MODEL 646.106990

HOW TO ORDER REPAIR PARTS

Now that you have purchased your Buffer/Polisher, should a need ever exist for repair parts or service, simply contact any Sears Service Center and most Sears Roebuck and Co. stores. Be sure to produce all pertinent facts when you call or visit. **The model number of your Buffer/Polisher will be found on top of the handle.**

WHEN ORDERING REPAIR PARTS, ALWAYS GIVE THE FOLLOWING INFORMATION:

- PART NUMBER
- MODEL NUMBER
- PART DESCRIPTION
- NAME OF ITEM

All parts listed may be ordered from any Sears Service Center and most Sears stores. If the parts are not stocked locally, your order will be electronically transmitted to a Sears Repair Parts Distribution Center for handling.

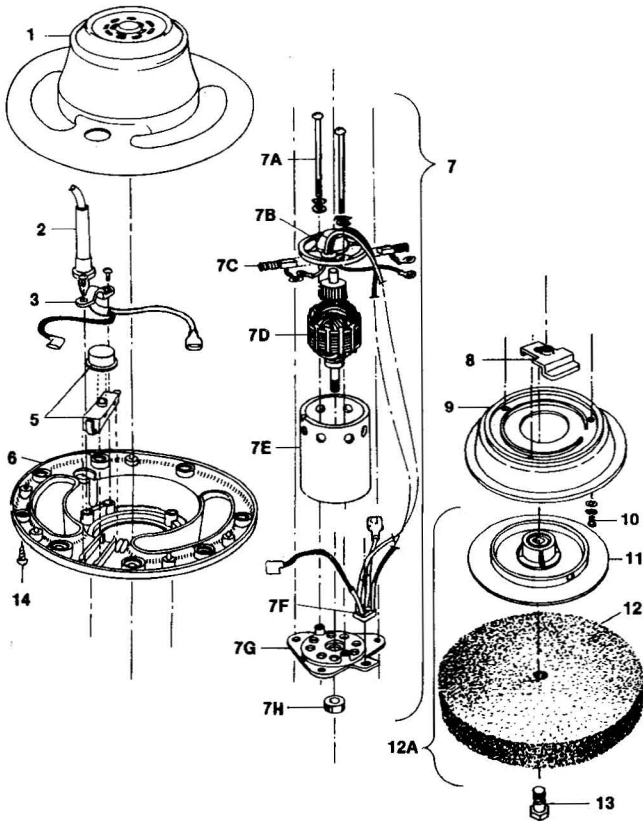

ACCESSORIES



SIMONIZ is a reg. U.S. trademark of First Brands Corporation

PARTS LIST

KEY PART NO.	NO.	DESCRIPTION	QTY.
1	PHT 405	Housing Top	1
2	CSA 400	Cord strain relief assy.	1
3	PRC 405	Cord Hold Down Bar	1
5	SWH 400	Switch	1
6	PHB 405	Housing Bottom	1
7	JMA 120	Motor Assy.	1
7A	TBA 400	Motor Thru Bolts (2) Washers, Lock Washers	2
7B	MEB 400	End Bell Assy.	1
7C	BRU 001	Motor Brush Set (Brushes, Clips, Springs)	1
7D	ARM 400	Armature	1
7E	MYA 400	Magnet, Yoke Assy.	1

KEY PART NO.	NO.	DESCRIPTION	QTY.
7F	MRA 400	Rectifier Assy.	1
7G	FMP 400	Motor Plate Assy.	1
7H	BRG 001	Motor Bearing	1
8	CWT 400	Counterweight	1
9	PHG 405	Guard	1
10	SCA 003	Screw Assy. (with Washer, Lock Washer)	3
11	PHA 400	Pad Holder Assy.	1
12	4018	Pad	1
12A	PHA 4018	Pad/Padholder assy. (Pre-assembled)	1
13	LHB 400	Left-Handed Threaded Bolt 5/16"	1
14	SCR 400	Housing Assy. Screws (Self-Threading)	8
	114A1104	Owners Manual	1

WAXMASTER is a reg. U.S. trademark of Waxing Corporation of America

© 1988, Sears Roebuck and Company
All Rights Reserved